

Department Design

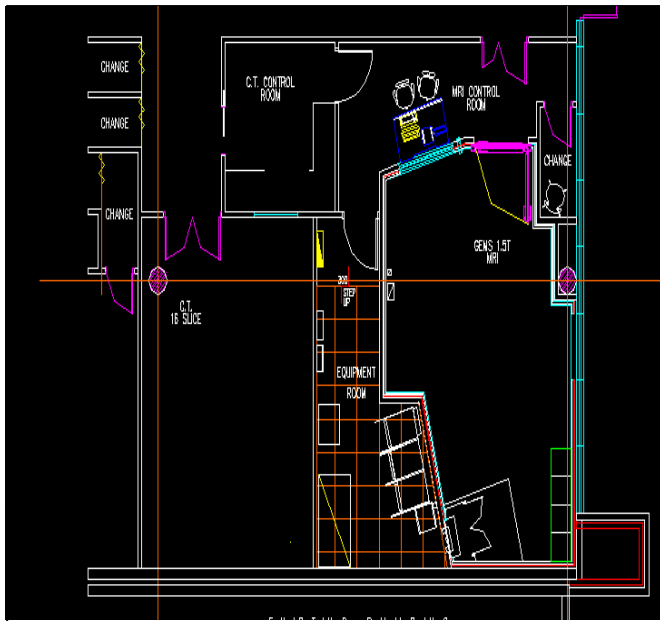

Inderlec Medical Systems offers complete design and drafting services to the Medical Imaging industry.

Forget engaging architects, applying for council approval, trying to meet local guidelines and all the other headaches that go with it.

Inderlec Medical Systems can provide full AUTOCAD diagrams for submission to council, we can co-ordinate the project for you and take all the stress out of your next project.

From the initial concept through to the point you are ready to move in, we can do the lot.

We have the experience and the capability of taking your next project from concept to completion.

Inderlec Medical Systems can save you thousands of dollars!

We can have as large or as small an involvement as you wish.

We can offer you the following;

- ⇒ Site Evaluation
- ⇒ Plan Designs
- ⇒ Shielding Calculations
- ⇒ Shielding Manufacture
- ⇒ Shielding Installation
- ⇒ Partition Installation
- ⇒ Gyprock work and Painting
- ⇒ Equipment Sourcing and Supply
- ⇒ Entire Project Coordination

You can pick and chose from the services we can offer.

If you have your own builders and only need us to design and supply the shielding, then that is not a problem.

We are as flexible as you need us to be.

Call us before starting your next project or you could be paying thousands of dollars too much

**Nuclear
Medicine**

**INDERLEC MEDICAL
SYSTEMS** PTY LTD

